

※ NOTES ※ (UNLESS OTHERWISE SPECIFIED)

MATERIAL

- ① CONTACT : STAINLESS STEEL SUS, T=0.17±0.03mm
MATTE TIN PLATED OVERALL

SPECIFICATION

- ① ELECTRICAL RESISTANCE : 100mΩ MAX.
- ② OPERATION TEMPERATURE : -25°C TO +150°C
- ③ STORAGE TEMPERATURE : -40°C TO +85°C

PACKAGING

- ① 10,000 PCS PER REEL
- ② 10 REELS PER CARTON

※※ THIS IS A RoHS 2.0 RECOGNIZED,
AND COMPLIANT PRODUCT.

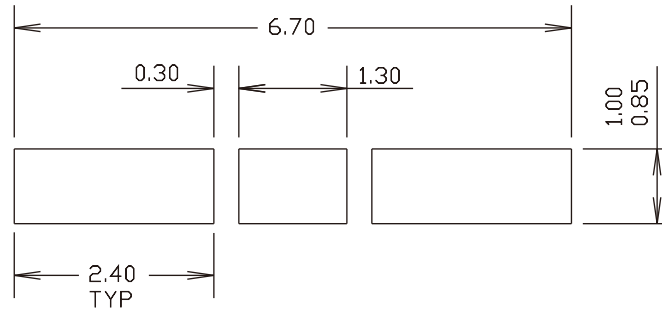
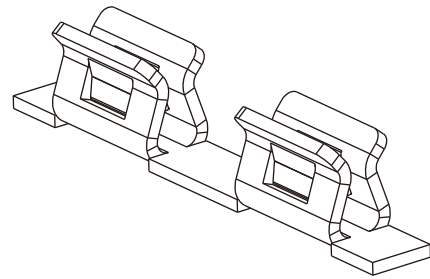
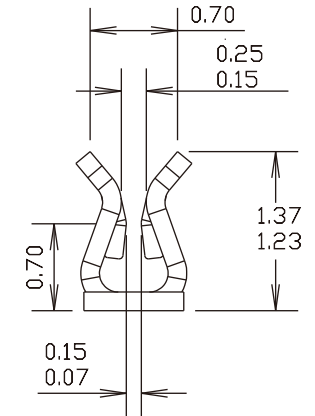
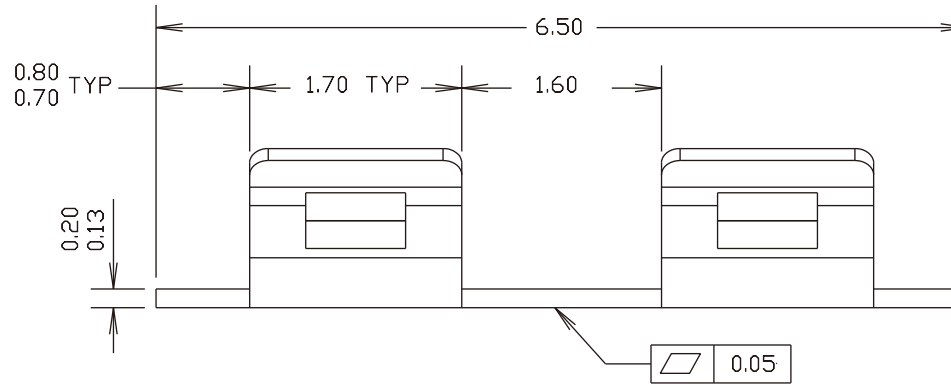
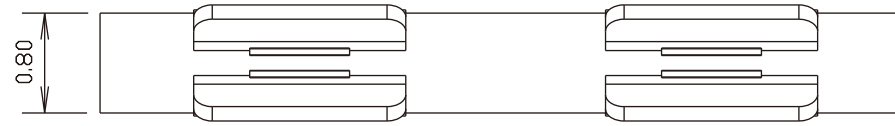

RECOMMENDED P.C.B. PAD LAYOUT

QUALITY CONTROL/INSPECTION DIMENSIONS SHALL MARKED THE SYMBOL AS ▲	METRIC		WIROS ELECTRONICS <small>INTERNATIONAL COMPANY LIMITED</small>	
	DRAWER SG, W		<small>NOTICE OF PROPRIETARY PROPERTY</small> <small>THIS DRAWING CONTAINS INFORMATION THAT IS PROPRIETARY TO</small> <small>WIROS ELECTRONICS INTERNATIONAL COMPANY LIMITED</small> <small>AND SHOULD NOT BE USED WITHOUT WRITTEN CONSENT FROM WIROS.</small>	
	APPROVER YC, Y			
	<small>DIMENSIONS ARE IN MILLIMETERS</small> <small>TOLERANCES</small>		TITLE	
<input checked="" type="checkbox"/> RoHS COMPLIANT <input checked="" type="checkbox"/> HIF HYPO-ALLERGY <input checked="" type="checkbox"/> P/B LEAD-FREE	X. ±1.00 X.X ±0.50 X.XX ±0.10 X.XXX ±0.01 ANGLES ±5°	SURFACE MOUNT RFI SHIELD CLIP L=6.50mm		
<small>DO NOT SCALE DRAWINGS</small> 		PRODUCT NUMBER		
THIRD ANGLE PROJECTION		RFIC001-SUS-SMD		
SIZE A4	REV. B	SCALE NONE	SHEET 1 OF 2	

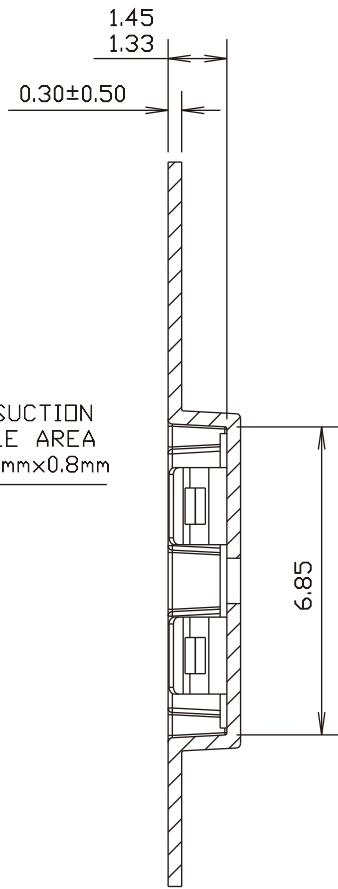
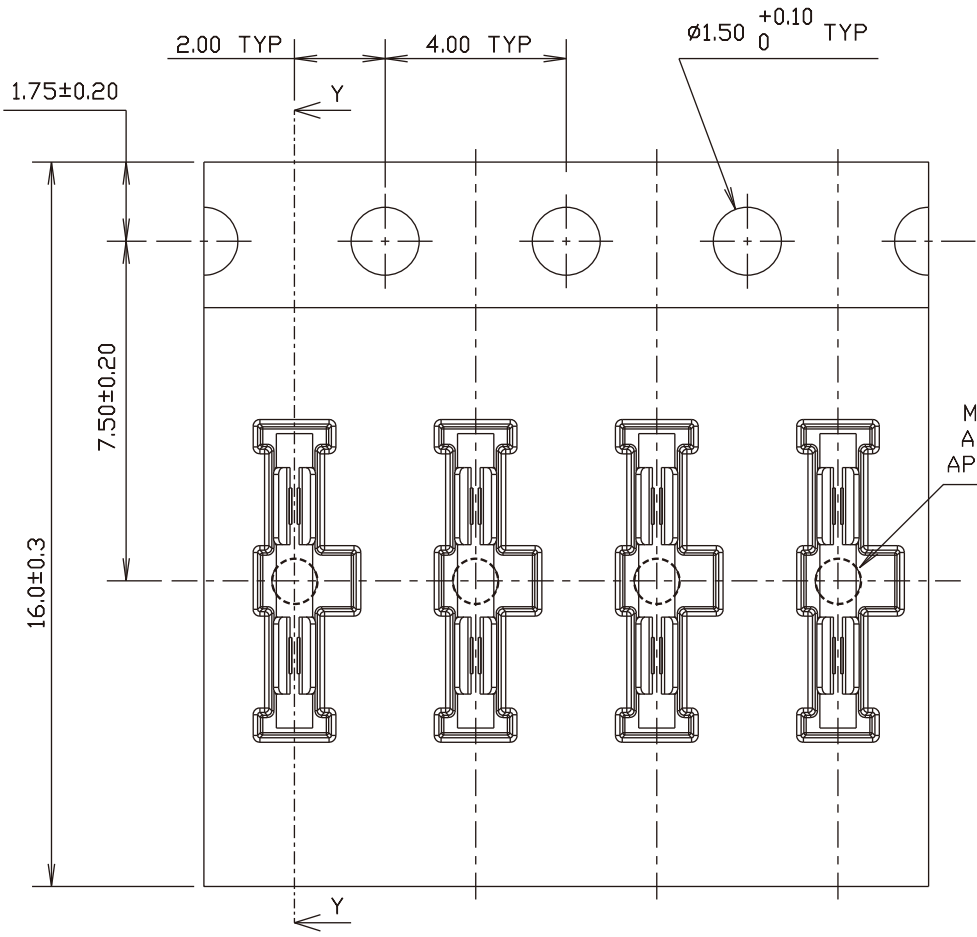

MACHINE SUCTION APPLICABLE AREA APPROX. 1.2mm x 0.8mm

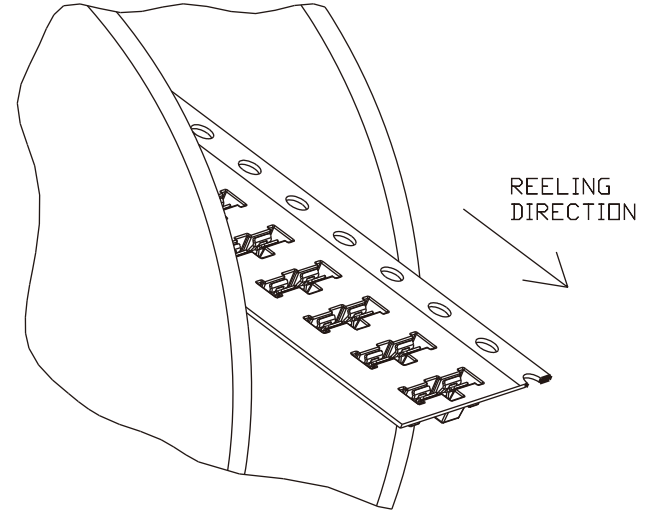

SECTION Y-Y

QUALITY CONTROL DIMENSIONS SHALL MARKED THE SYMBOL AS	METRIC		WIROS ELECTRONICS <small>INTERNATIONAL COMPANY LIMITED</small>	
	DRAWER SG, W		<small>NOTICE OF PROPRIETARY PROPERTY</small> <small>THIS DRAWING CONTAINS INFORMATION THAT IS PROPRIETARY TO</small> <small>WIROS ELECTRONICS INTERNATIONAL COMPANY LIMITED</small> <small>AND SHOULD NOT BE USED WITHOUT WRITTEN CONSENT FROM WIROS.</small>	
APPROVER YC, Y		<small>DIMENSIONS ARE IN MILLIMETERS</small> <small>TOLERANCES</small>		TITLE
<input checked="" type="checkbox"/> RoHS COMPLIANT <input checked="" type="checkbox"/> HF <input checked="" type="checkbox"/> LEAD FREE	X. ±1.00 X.X ±0.50 X.XX ±0.10 X.XXX ±0.01 ANGLES ±5°	SURFACE MOUNT RFI SHIELD CLIP L=6.50mm		
<small>DO NOT SCALE DRAWINGS</small> 		<small>THIRD ANGLE PROJECTION</small>		PRODUCT NUMBER RFIC001-SUS-SMD
SIZE A4	REV. B	SCALE NONE	SHEET 2 OF 2	