

* NOTES * (UNLESS OTHERWISE SPECIFIED)

MECHANICAL

- ① HOUSING : THERMOPLASTIC LCP, UL94V-0, COLOR BEIGE
- ② CONTACT : PHOSPHOR BRONZE, TIN PLATED OVER NICKEL
- ③ SOLDER PEG : PHOSPHOR BRONZE, TIN PLATED OVER NICKEL

SPECIFICATION

- ① CURRENT RATING : 1.0 AMPHERES MAX.(AWG#28)
- ② VOLTAGE RATING : 50V AC/DC MAX.
- ③ CONTACT RESISTANCE : 20 MILLIOHM MAX.
- ④ INSULATION RESISTANCE : 100 MEGOHM MIN.
- ⑤ DIELECTRIC STRENGTH : 500V AC/MINUTE
- ⑥ OPERATING TEMPERATURE : -40°C TO +85°C
- ⑦ IR-REFLOW PEAK-TEMP. : 260±5°C FOR 3±0.5 SECONDS
- ⑧ APPLICABLE WIRES : AWG.#28~#32

*** THIS IS A RoHS-2 RECOGNIZED PRODUCT
 *** MATES WITH PWB10 SERIES HOUSING AND CRIMP TERMINALS

ORDER OPTION(S)

RWB10-12JR0 ** G3

NUMBER OF POSITIONS
 FROM 02~20 AVAILABLE

DIMENSION TABLE

PART NUMBER	A	B	C
RWB10-12JR002G3	1.0	4.0	2.6
RWB10-12JR003G3	2.0	5.0	3.6
RWB10-12JR004G3	3.0	6.0	4.6
RWB10-12JR005G3	4.0	7.0	5.6
RWB10-12JR006G3	5.0	8.0	6.6
RWB10-12JR007G3	6.0	9.0	7.6
RWB10-12JR008G3	7.0	10.0	8.6
RWB10-12JR009G3	8.0	11.0	9.6
RWB10-12JR010G3	9.0	12.0	10.6
RWB10-12JR011G3	10.0	13.0	11.6
RWB10-12JR012G3	11.0	14.0	12.6
RWB10-12JR013G3	12.0	15.0	13.6
RWB10-12JR014G3	13.0	16.0	14.6
RWB10-12JR015G3	14.0	17.0	15.6
RWB10-12JR016G3	15.0	18.0	16.6
RWB10-12JR017G3	16.0	19.0	17.6
RWB10-12JR018G3	17.0	20.0	18.6
RWB10-12JR019G3	18.0	21.0	19.6
RWB10-12JR020G3	19.0	22.0	20.6

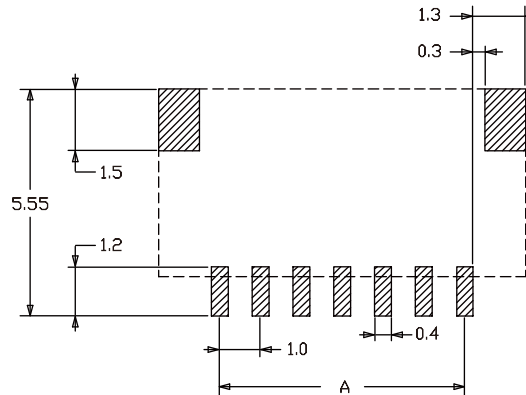
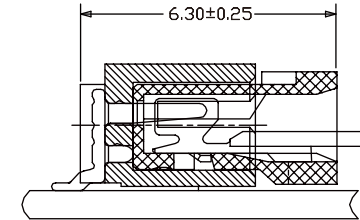
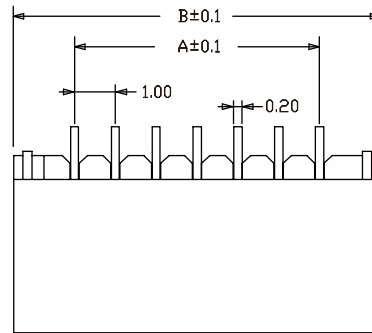
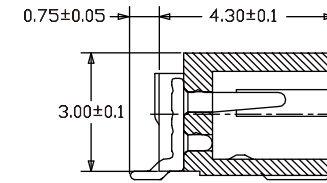
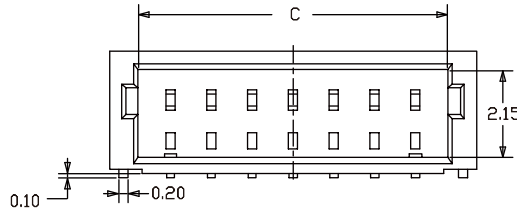

RECOMMENDED P.C.B. LAYOUT
 (TOP VIEW)
 TOLERANCE ±0.05mm

METRIC		WIROS ELECTRONICS INTERNATIONAL COMPANY LIMITED	
DRAWER	HENRY, W	NOTICE OF PROPRIETARY PROPERTY THIS DRAWING CONTAINS INFORMATION THAT IS PROPRIETARY TO WIROS ELECTRONICS INTERNATIONAL COMPANY LIMITED AND SHOULD NOT BE USED WITHOUT WRITTEN CONSENT FROM WIROS.	
APPROVER	CR, S		
DIMENSIONS ARE IN MILLIMETERS TOLERANCES		TITLE	
X.	----	1.00 WIRE TO BOARD SIDE ENTRY SMD CONNECTOR	
X.X	±0.20		
X.XX	±0.15		
X.XXX	±0.10		
ANGLES	±3°		
DO NOT SCALE DRAWINGS		PRODUCT NUMBER	
 THIRD ANGLE PROJECTION		RWB10-12JR0**G3	
		SIZE	REV.
A4		NONE	