

\* NOTES \* (UNLESS OTHERWISE SPECIFIED)

MECHANICAL

- ① HOUSING : THERMOPLASTIC LCP, UL94V-0, COLOR BEIGE
- ② CONTACT : COPPER ALLOY, GOLD 0.2~1μ PLATED OVER NICKEL
- ③ SOLDER PEG : BRASS, TIN PLATED OVER NICKEL

SPECIFICATION

- ① CURRENT RATING : 0.2 AMPHRE AC/DC
- ② VOLTAGE RATING : 30VDC
- ③ CONTACT RESISTANCE : 30 MILLIOHMS MAX.
- ④ INSULATION RESISTANCE : 100 MEGOHMS MIN.
- ⑤ WITHSTAND VOLTAGE : 200V AC/MINUTE
- ⑥ OPERATING TEMPERATURE : -25°C TO +85°C
- ⑦ IR-REFLOW PEAK-TEMP. : 260±5°C FOR 3±0.5 SECONDS
- ⑧ APPLICABLE WIRE : AWG.#36

\*\*\* THIS IS A RoHS-2 RECOGNIZED PRODUCT  
 \*\*\* MATES WITH PWB06 SERIES HOUSING AND TERMINALS

ORDER OPTION(S)

RWB06-120R0  F3

NUMBER OF POSITIONS  
 02,04~08,10,12,14,16 AVAILABLE

DIMENSION TABLE

PART NUMBER	A	B	C	D
RWB06-120R002F3	0.60	1.36	3.00	2.35
RWB06-120R004F3	1.80	2.56	4.20	3.55
RWB06-120R005F3	2.40	3.16	4.80	4.15
RWB06-120R006F3	3.00	3.76	5.40	4.75
RWB06-120R007F3	3.60	4.36	6.00	5.35
RWB06-120R008F3	4.20	4.96	6.60	5.95
RWB06-120R010F3	5.40	6.16	7.80	7.15
RWB06-120R012F3	6.60	7.36	9.00	8.35
RWB06-120R014F3	7.80	8.56	10.20	9.55
RWB06-120R016F3	9.00	9.76	11.40	10.75

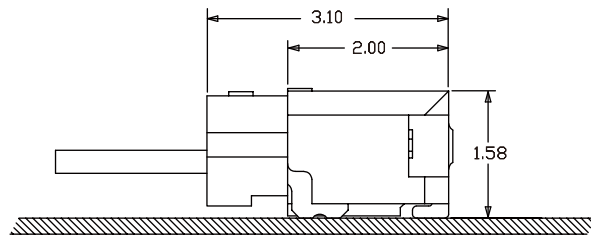
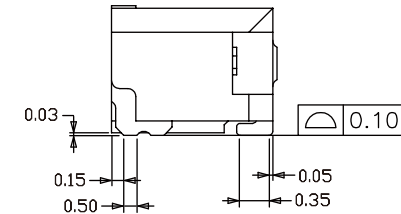
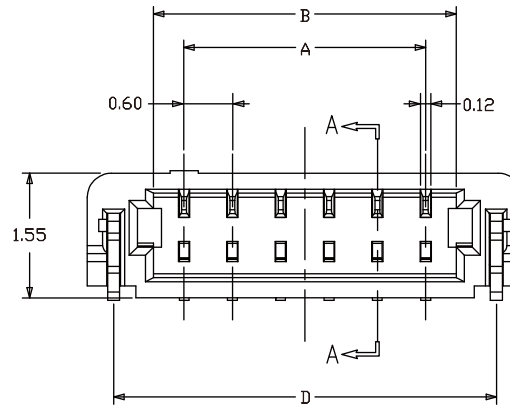
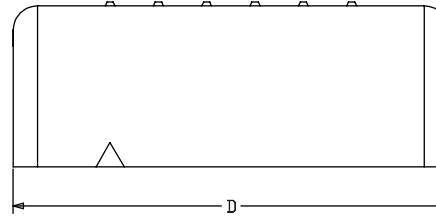

PLUG MATED DIAGRAM

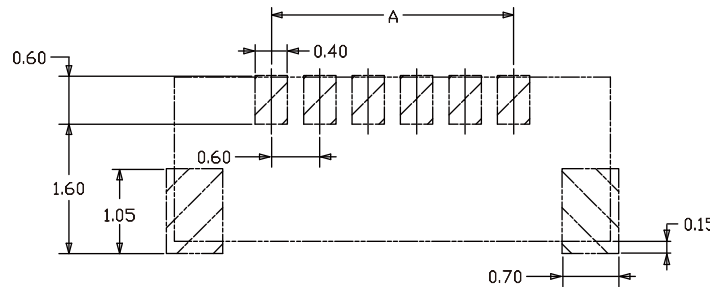

RECOMMENDED P.C.B. LAYOUT  
 (TOP VIEW)  
 TOLERANCE ±0.05mm

METRIC		WIROS ELECTRONICS INTERNATIONAL COMPANY LIMITED	
DRAWER	HENRY, W	NOTICE OF PROPRIETARY PROPERTY THIS DRAWING CONTAINS INFORMATION THAT IS PROPRIETARY TO WIROS ELECTRONICS INTERNATIONAL COMPANY LIMITED AND SHOULD NOT BE USED WITHOUT WRITTEN CONSENT FROM WIROS.	
APPROVER	HENG, LAI		
DIMENSIONS ARE IN MILLIMETERS TOLERANCES		TITLE	
X. ----- X.X ±0.25 X.XX ±0.15 X.XXX ±0.10 ANGLES ±3°		0.60 WIRE TO BOARD IDC SIDE ENTRY SMD CONNECTOR	
DO NOT SCALE DRAWINGS		PRODUCT NUMBER	
THIRD ANGLE PROJECTION		RWB06-120R0**F3	
SIZE	REV.	SCALE	SHEET 1 OF 1
A4		5 : 1	