

NOTES : (UNLESS OTHERWISE SPECIFIED)

MATERIAL

- ① HOUSING : HIGH-TEMPERATURE THERMOPLASTIC, UL94V\_0, SELECTIVE COLOR
- ② CONTACTS : COPPER ALLOY, SQ=0.4mm, SELECTIVE ELECTRO-PLATING

SPECIFICATION

- ① CURRENT RATING : 1 AMP
- ② INSULATOR RESISTANCE : 500 MEGOHMS MIN.
- ③ DIELECTRIC WITHSTANDING : AC 500V
- ④ CONTACT RESISTANCE : 20 MILLIOHMS MAX.
- ⑤ OPERATING TEMPERATURE : -40°C ~ +105°C
- ⑥ WAVE-SOLDERING PEAK TEMPERATURE  
THERMOPLASTIC-PA6T : 260±5°C FOR 5-10 SEC(s)  
HIGH-TEMPERATURE P.B.T. : 250±5°C FOR 5 SEC(s)

PRODUCT ORDER OPTION

PHD \*\* - \* \* \* P2X \*\* J6

-----  
POSITION NO. (02~40 MAX.)

-----  
PLATING

- A~Au 0.2~1μ OVERALL
- B~Au 3μ OVERALL
- E~Au 15μ OVERALL
- J~Sn 80~100μ OVERALL
- 

-----  
HOUSING COLOR

- 1~BLACK 2~BEIGE
- 3~WHITE
- 

-----  
HOUSING MATERIAL

- 3~THERMOPLASTIC-PA6T
- 6~HIGH-TEMPERATURE P.B.T.
- 

-----  
DIMENSION CODE (RANDOM)

- 22~DIM.A=2.3mm, DIM.B=2.5mm, DIM.C=20mm
- 26~DIM.A=2.3mm, DIM.B=2.5mm, DIM.C=26mm
- 

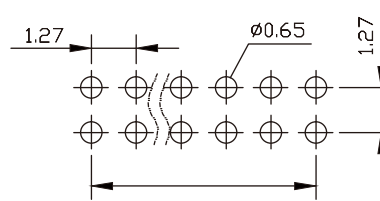
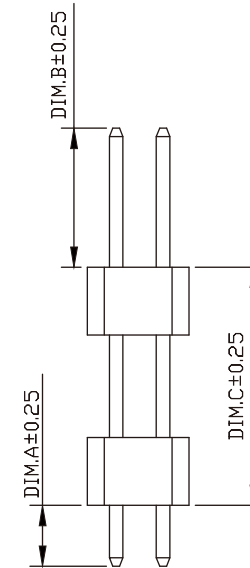
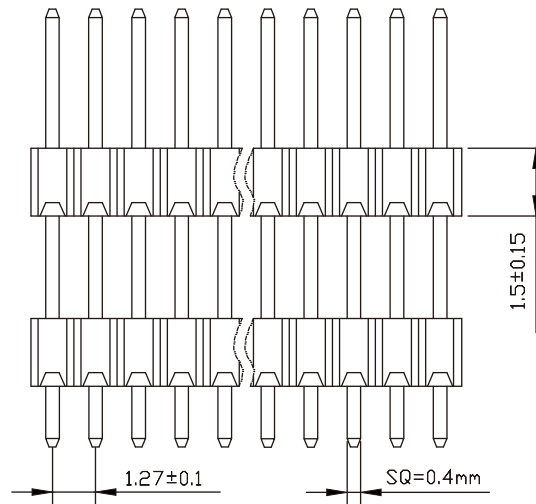
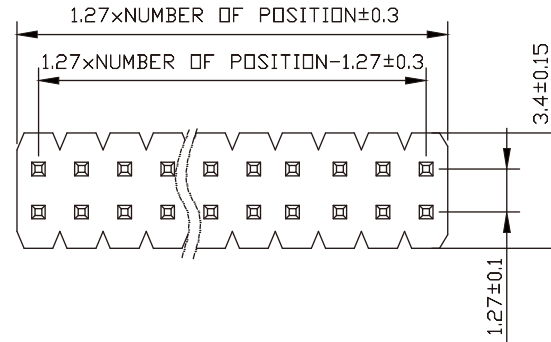

1.27xNUMBER OF POSITION-1.27

RECOMMENDED P.C.B. LAYOUT

LEAD FREE PRODUCT	METRIC	
	DRAWER	
RoHS Directive compliant 2002/95/EC	DIMENSIONS ARE IN MILLIMETERS TOLERANCES X.X ±0.35 X.XX ±0.25 X.XXX ±0.10 ANGULAR ±3°	TITLE <b>MALE HEADER          1.27mm VERTICLE          DUAL ROW          THROUGH HOLE</b>
	SIZE <b>A4</b>	PRODUCT NO. <b>PHD**-* **P2X**J6</b>
THIRD ANGLE PROJECTION	SHEET NO. <b>1 OF 1</b>	SCALE <b>N/A</b>